

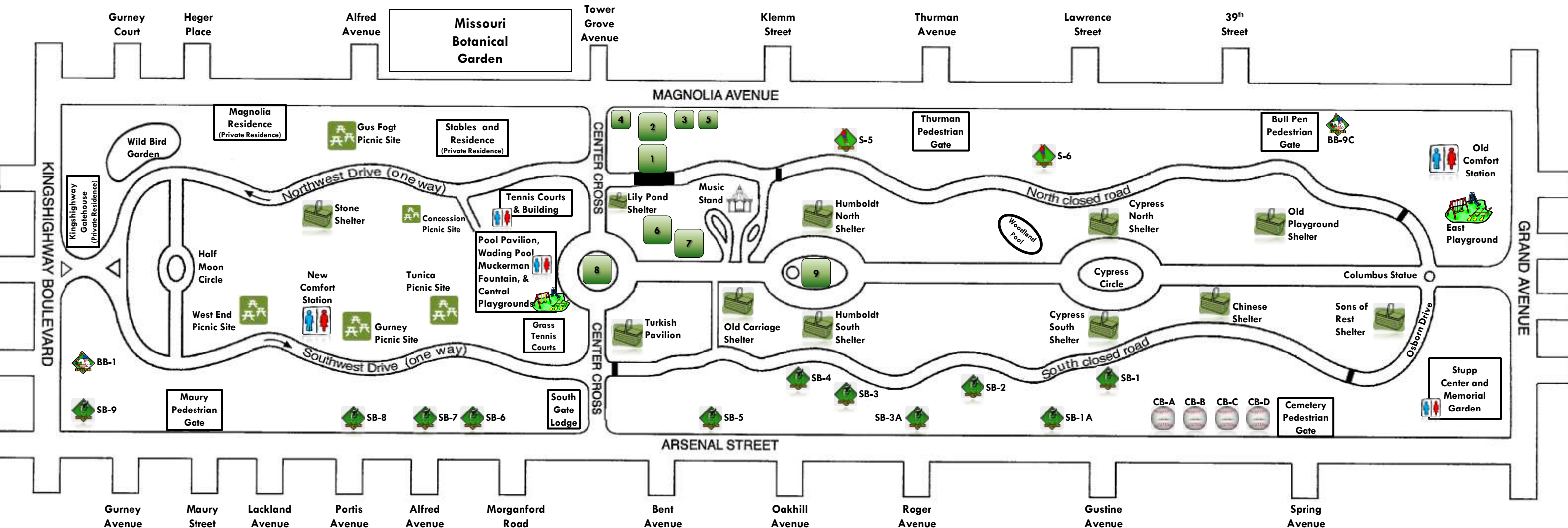

Tower Grove Park Map

4256 Magnolia Avenue
St. Louis, Missouri 63110
314-771-2679

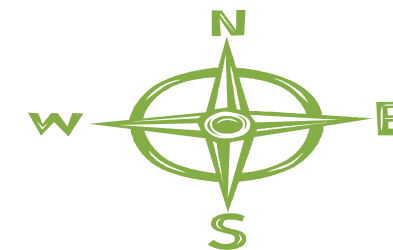

Tower Grove Park is open daily from sunrise to 10 p.m.
Tower Grove Park is a public park owned by the City of St. Louis, and governed by a Board of Commissioners appointed under the authority of the Missouri Supreme Court.
Tower Grove Park is a National Historic Landmark founded and donated by Henry Shaw.

Visit us at www.towergrovepark.org

- Legend:**
- 1 – Piper Palm House
 - 2 – Piper Plant House (**Park Office**)
 - 3 – Park Greenhouse
 - 4 – Director’s Residence
 - 5 – Park Maintenance Complex
 - 6 – Lily Ponds
 - 7 – Ruins and Fountain Pond
 - 8 – Shakespeare Statue and Flag Circle
 - 9 – Humboldt Statue and Humboldt Circle

- Ball fields Legend:**
- BB = Baseball
 - S = Soccer
 - SB = Softball
 - CB = Corkball